

2020-2021



American Bowling Service, Inc.

BOWLING CATALOG



NANODESU
COLUMBIA300
TRACK
MOTIV
900GLOBAL
PRO-am
ABS

BALLS

2020-2021 / BALLS BAGS SHOES

NANODESU

Team Captain



Daisuke Tasaka



Yukari Honma



NANODESU 8

Coverstock Nano-Thane 2.0 Solid
 Core ∞ 4x8 HV Core
 RG/ Δ RG 2.570/0.052
 Finish #600, #1000, #2000, #4000Abralon
 Hardness 74~76°
 InterDiff 0.000
 Weights 11~16lbs



Made in Japan



NANODESU ACCU RISE 6

Coverstock Nano-Thane 3.0 Pearl
 Core SS Premium α
 RG/ Δ RG 2.480/0.053
 Finish 1000 Abralon Diamond Compound 2 Polish
 Hardness 74~76°
 InterDiff 0.016
 Weights 11~16lbs



Made in Japan



NANODESU GRASP

Coverstock Nano-Thane 6.0 Solid (LEVEL.6)
 Core Modified BIG Drum Core
 RG/ Δ RG 2.501/0.045
 Finish 3000Abralon
 Hardness 74~76°
 InterDiff 0.014
 Weights 11~16lbs



Made in Japan



ACCU LINE TOUR PREMIUM 3

Coverstock Nano-Thane 2.0 Hybrid (LEVEL.2)
 Core Modified Premium Core
 RG/ Δ RG 2.460/0.055
 Finish #1000 Diamond Polish II
 Hardness 74~76°
 InterDiff 0.016
 Weights 11~16lbs



Made in Japan



PURE RISE NANODESU

Coverstock Premium Pure Urethane With Nano/fullerene C60
 Core HRL Δ Core
 RG/ Δ RG 2.538/0.035
 Finish #4000Abralon
 Hardness 74~76°
 InterDiff 0.000
 Weights 12~16lbs



Made in Japan

DRAGON



CYGNUS



PEGASUS



ANDROMEDA



Fortune



Fortune

Discontinued item / limited stock



Made in Japan



	Coverstock	Core	Finish	RG	Δ RG	InterDiff	Hardness	Weights
DRAGON	SG 78	Modified	#600 Diamond Compound II Polish	2.512	0.048	0.000	74° ~ 76°	10-16 lbs
CYGNUS	SG 76	Dia Symmetry Core	#1000 Diamond Compound II Polish					
PEGASUS	SG 74		#2000 Diamond Compound II Polish					
ANDROMEDA	SG 72		#4000 Diamond Compound II Polish					

BALLS



MOTIV

Team Captain



Takuya Murakami



Ssachi Yamada

PBA Player



EJ Tackett



Maria Jose Rodriguez



ALPHA JACKAL

Coverstock Coercion HV3
Solid Reactive
Core Predator V2
RG/ΔRG 2.470/0.054
Finish 2000 Grit LSS
Hardness 74 ~ 76°
InterDiff 0.015
Weights 14 ~ 16lbs



TRIDENT NEMESIS

Coverstock Infusion HV Pearl Reactive
Core Sidewinder
RG/ΔRG 2.520/0.049
Finish 5500 Grit LSS
Hardness 74 ~ 76°
InterDiff 0.013
Weights 14 ~ 16lbs



REVOLT2020

Coverstock Coercion HFS Reactive
Core Vanquish
RG/ΔRG 2.470/0.056
Finish 3500 Grit LSS
Hardness 74 ~ 76°
InterDiff 0.000
Weights 12 ~ 16lbs



RIPCORD FLIGHT

Coverstock Turmoil Max Solid Reactive
Core Oblivion
RG/ΔRG 2.530/0.047
Finish 3000 Grit LSS
Hardness 74 ~ 76°
InterDiff 0.000
Weights 14 ~ 16lbs



SUPRA

Coverstock Infusion Pearl
Core High Impulse
RG/ΔRG 2.570/0.050
Finish 5500 Grit LSP
Hardness 74 ~ 76°
InterDiff 0.000
Weights 12 ~ 16lbs



TANK BLITZ

Coverstock Friction + Microcell Polymer
Core Gear
RG/ΔRG 2.480/0.034
Finish 2000 Grit LSS
Hardness 74 ~ 76°
InterDiff 0.000
Weights 14 ~ 16lbs





Team Captain



AUTHORITY

Coverstock ERT2.0Hybrid
 Core Authority
 RG/ΔRG 2.503/0.050
 Finish 500/1000 Siaair
 CF Compound
 Hardness 74~76°
 InterDiff 0.020
 Weights 12~16lbs

Made in Mexico



OUTLOOK

Coverstock Exciter Max
 Core Outlook
 RG/ΔRG 2.533/0.047
 Finish 500/1000/3000 Siaair CF Compound
 Hardness 74~76°
 InterDiff 0.000
 Weights 12~16lbs

Made in Mexico

MESSENGER

Coverstock Super Flex
 Core Messenger
 RG/ΔRG 2.570/0.021
 Finish 500/2000Abralon Polish
 Hardness 74~76°

Made in U.S.A

Discontinued item /limited stock



Gold/Black (10-15lbs) Red/Black (10-16lbs) Pink/Purple (10-16lbs)

WHITE DOT

Coverstock Polyester
 Hardness 80~83°

Made in Mexico



Black/Purple/Silver (9-16lbs) Diamond (13-15lbs) Lava Fire (10-15lbs) Patriot Sparkle (9-15lbs) Pink/Black (10-15lbs)

THE BEAST

Coverstock Bend-It
 Core Beast
 RG/ΔRG 2.540/0.035
 Finish 500/2000 Abralon Polish
 Hardness 74~76°
 Weights 10~15lbs

Made in Mexico



Black/Pink/Purple Blue/Red/Black Purple/Sparkle

LATITUDE

Coverstock QR8 Solid
 Core MC2
 RG/ΔRG 2.511/0.045
 Finish 500/3000 Siaair
 Hardness 74~76°
 InterDiff 0.000
 Weights 12~16lbs

Made in Mexico



Team Captain



PROOF

Coverstock Prime Response
 Core Proof
 RG/ΔRG 2.519/0.052
 Finish 500/2000 Siaair
 Hardness 74~76°
 InterDiff 0.020
 Weights 12~16lbs

Made in Mexico



Ryuta Ichihara

Ayaka Kubota

PBA Player



KINETIC OBSIDIAN

Coverstock DR-7 SOLID
 Core Modified KINETIC
 RG/ΔRG 2.490/0.038
 Finish 500/2000 Abralon
 Hardness 74~76°
 Hardness 0.005
 Weights 12~16lbs

Made in U.S.A



HEAT LAVA

Coverstock QR-7 PEARL
 Core MODIFIED TRI-CORE
 RG/ΔRG 2.500/0.038
 Finish 500/1000 Abralon Polished
 Hardness 74~76°
 Hardness 0.000
 Weights 12~16lbs

Made in U.S.A



TRITON ELITE

Coverstock QR-7 Solid
 Core MC2 Technology
 RG/ΔRG 2.510/0.046
 Finish 500/2000 Abralon
 Hardness 74~76°
 Hardness 0.000
 Weights 10~16lbs

Made in U.S.A



Jake Peters

Matt Saunders

BALLS

900 GLOBAL Team Captain



Hidekazu Wada



Aki Nawa

PBA Player



Chris Barnes



Daria Pajak



VOLT SOLID

Coverstock S72R Solid Reactive
Core Charged Symmetric
RG/ΔRG 2.560/0.047
Finish 2000 Abralon
Hardness 74 ~ 76°
InterDiff 0.000
Weights 14 ~ 16lbs

Made in U.S.A



ORDNANCE PEARL

Coverstock S70 Pearl Reactive
Core Projectile Symmetric
RG/ΔRG 2.540/0.054
Finish 1500 Polished
Hardness 74 ~ 76°
InterDiff 0.000
Weights 12 ~ 16lbs

Made in U.S.A



BADGER PINK FURY

Coverstock S71 Solid
Core Lacerate Symmetric
RG/ΔRG 2.570/0.041
Finish 1500 Grit Polished
Hardness 74 ~ 76°
InterDiff 0.000
Weights 12 ~ 16lbs

Made in U.S.A



FLUX PEARL

Coverstock S72R Pearl Reactive
Core Amplify Asymmetric
RG/ΔRG 2.550/0.048
Finish 1500 Grit Polished
Hardness 74 ~ 76°
InterDiff 0.014
Weights 14 ~ 16lbs

Made in U.S.A



GEAR GOLIATH

Coverstock 74 Response Pearl
Core Identity Asymmetric
RG/ΔRG 2.480/0.054
Finish 1500 Grit Polished
Hardness 74 ~ 76°
InterDiff 0.024
Weights 14 ~ 16lbs

Made in U.S.A



BOOST

Core ILaunch Sym
RG/ΔRG 2.540/0.043
Finish 2000 Grit Polished
Hardness 74 ~ 76°
Weights 10 ~ 16lbs

Made in U.S.A

Discontinued item / limited stock



Black/Gray/Silver Coverstock S43 Pearl | Green/Silver/Blue Coverstock S43 Pearl | Bubblegum Coverstock S43 Pearl | Blue/Black Coverstock S43 Hybrid

PRO-AM

Team Captain



Daisuke Tida



Yuka Uyama

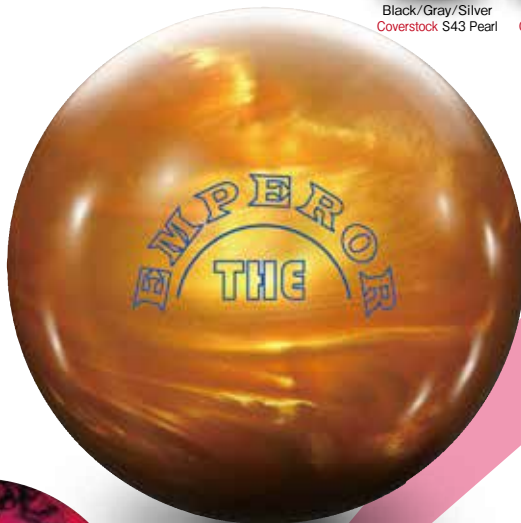

THE EMPEROR GOLD

Coverstock Select Premium Pearl Reactive
Core Imperial Core
RG/ΔRG 2.500/0.047
Finish 1500 Grit Polished
Hardness 74 ~ 76°
InterDiff 0.000
Weights 12 ~ 16lbs

Made in U.S.A



INVADER PHOENIX

Coverstock MO5.7H α
Core ∞2.50
RG/ΔRG 2.500/0.049
Finish 1500 Grit Polished
Hardness 74 ~ 76°
InterDiff 0.000
Weights 12 ~ 16lbs

Made in U.S.A



SUPER VOLANTE

Coverstock Ultra Hook Hybrid Reactive
Core Blaster Core
RG/ΔRG 2.520/0.052
Finish 1500 Grit Polished
Hardness 74 ~ 76°
InterDiff 0.000
Weights 12 ~ 16lbs

Made in U.S.A





LRG (10-15lbs)



MRG (8-16lbs)



HRG (10-15lbs)



Gyratation 2

[LRG]	Coverstock	R78 Pearl
	Core	LRG CORE
	RG/ΔRG	2.48/0.049
	Finish	10,000 Grit Polish
	Hardness	74-76
[MRG]	Coverstock	R74 Pearl
	Core	MRG CORE
	RG/ΔRG	2.520/0.048
	Finish	1,000 Grit Polish
	Hardness	74-76
[HRG]	Coverstock	R70 Pearl
	Core	HRG CORE
	RG/ΔRG	2.560/0.047
	Finish	4,000 Grit Polish
	Hardness	74-76



Black (8-15lbs)



Blue (8-15lbs)



Purple (6-16lbs)



Jubilee

Coverstock	Pure Urethan
Hardness	75°-78°



Black (8-15lbs)



Blue (8-15lbs)



Red (8-15lbs)



Purple (6-16lbs)



Pink (8-15lbs)



LA VIE

Coverstock	Polyester
Hardness	78°-80°



Multi Black (12-16lbs)



Multi Blue (12-16lbs)



Multi Pink (12-16lbs)



Sureline Hard

Coverstock	Super Hard Polyester
Hardness	82°-85°



BAGS

2020-2021 / BALLS BAGS SHOES



Black

Red

Blue

Green



B20-2380

Dimensions : W810×D370×H530mm
Materials : 1680D Polyester



Features



Silent Running Urethane Wheels



Name Card Pocket



Foam Insulation



Air Vents



Accessory Box



Rubber Handle



Shoe Storage



Outside Pocket



Double Zipper



YKK Zipper

Options



Urethane Front Wheel



Pulling Strap



Duluxe Pulling Strap



Big Shoulder Strap



Red



Blue



Black



B20-980T

Dimensions : W680×D230×H230mm
Materials : 1680D Polyester, PVC



Features



Foam Insulation



Rubber Handle



Double Zipper



YKK Zipper



See-Through

BAGS



B20- 1400T Original Shipping Cover

Helps protect your bag from dirt and damage during transit.



Convenient pocket sized for shipping labels

B20-1400T

3

Features

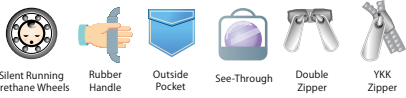

Dimensions : W690×D220×H270mm
Materials : 1680D Polyester



Attachable accessory bag



Can be used as a backpack

B20-250T

Dimensions : W580×D220×H150mm
Materials : 1680D Polyester

Features

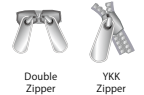

B20-1500

Dimensions : W520×D310×H480mm
Materials : 1680D Polyester

Features



Options

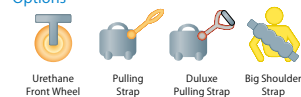



Green

Red

Blue

Black

2



B20-1180

Dimensions : W580×D260×H360mm
Materials : 600D Polyester

Features



Black



Red



Blue



B20-1250

Dimensions : W450×D310×H460mm
Materials : 1680D Polyester

Features



2

Options



Red



Blue



Black

2



B20-880

Dimensions : W450×D270×H320mm
Materials : 1680D Polyester

Features



Options



BAGS



Black



Blue



Red



2

Features

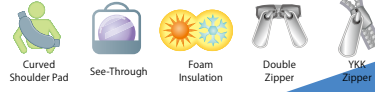

B20-440

Dimensions : W430×D230×H230mm
Materials : 1680D Polyester



Blue



Red



Green



Black



1

Features



B20-650

Dimensions : W400×D260×H360mm
Materials : 600D Polyester



Green



Black



Red



Blue



1

Features



B20-630

Dimensions : W400×D320×H360mm
Materials : 1680D Polyester



Sky Blue



Red



Purple



Black



Blue



Green



B20-330

Dimensions : W320×D235×H330mm
Materials : 1680D Polyester

Features



Red



Black



Sky Blue



Purple



Blue



Green



B20-320

Dimensions : W290×D250×H310mm
Materials : 1680D Polyester

Features



Purple



Sky Blue



Red



Green



Black



Blue



B20-200

Dimensions : W225×D210×H225mm
Materials : 1680D Polyester

Features



BAGS



Green



Sky Blue



Red



Black



Purple



Blue



B20-110

Dimensions : W230×D220×H540mm
Materials : 1680D Polyeste



Red



Blue



Black



Green



B20-370NP

Dimensions : W250×D180×H115mm
Materials : 1680D Polyeste

Features



Blue



Red



Black



B20-350P

Dimensions : W240×D145×H130mm
Materials : 1680D Polyester

Features

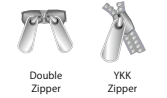

Pro-am Tour 4

Dimensions : W500×D265×H690mm
Materials : Duralumin
•Available by order



Made in Japan



Pro-am Tour 2

Dimensions : W450×D260×H500mm
Materials : Duralumin
•Available by order



Made in Japan





Features & Options

Production Number	B20-2380	B20-980T	B20-1400T	B20-250T	B20-1500	B20-1180	B20-1250	B20-880	B20-440	B20-650	B20-630	B20-330	B20-320	B20-200	B20-110	B20-370NP	B20-350P
Page Reference	P 8	P 8	P 9	P 9	P 9	P 10	P 10	P 10	P 11	P 11	P 11	P 12	P 12	P 12	P 13	P 13	P 13
Outside Pocket Useful pocket for accessories attached to the outside of the bag.		•	•	•	•	•	•			•	•	•	•				
Shoe Storage Protects your shoes and keeps the bag clean.		•			•	•	•			•	•	•	•				
Air Vents Allows for excellent ventilation and air circulation to help prevent odor and bacterial growth.		•			•	•	•			•	•	•	•				
Waist Pad Added comfort and support.					•		•										
Foam Insulation Special foam inner lining.		•	•		•	•	•	•	•	•	•						
Name Card Pocket Personalize with your name by inserting a card with the appropriate lettering.		•						•									
Rubber Handle Very useful when carrying and picking up.		•	•	•	•		•										
See-Through Allows to see the inside without opening.			•	•				•	•					•			
Accessory Box Plastic accessory box for all of your accessories and supplies. (The design is subject to change.)		•															
Silent Running Urethane Wheels Smooth and silent urethane wheels with easy glide bearings, Durability is unsurpassed.		•	•		•												
Wide Urethane Casters Heavy loads roll smoothly.							•	•									
Big Shoulder Pad OPTION Featuring thick sponge padding to help reduce pressure on shoulder and back.																	
Curved Shoulder Pad 8-mm thick. The Curve fits the shoulder like a glove.							•	•	•	•	•						
Standard Shoulder Pad Made of non-slip rubber for added support.												•	•				
Urethane Front Wheel OPTION Attaches to carts, made of smooth and silent rolling urethane.																	
Pulling Strap OPTION Easy to attach hook.																	
Deluxe Pulling Strap OPTION Firm rubber handle for easy pulling.																	
Double Zipper For more packing flexibility in any situation.																	
YKK Zipper World famous fasteners		•	•	•	•	•	•	•	•	•	•	•	•	•	•	•	•

OP Options Sold Separately



SHOES

2020-2021 / BALLS BAGS SHOES



White/Silver



Black/Black

SIZE
EE
SIZE



KANGAROO SHOES



NV-4

Materials : Ultra-Fine Kangaroo Leather,
EVA, Rubber, Velcro

		20.0	21.0	22.0	22.5	23.0	23.5	24.0	24.5	25.0	25.5	26.0	26.5	27.0	27.5	28.0	28.5	29.0	29.5	30.0
Black/Black	Right	—	—	○	○	○	○	○	○	○	○	○	○	○	○	○	—	—	—	—
	Left	—	—	○	○	○	○	○	○	○	○	○	○	○	○	○	—	—	—	—
White/Silver	Right	—	—	○	○	○	○	○	○	○	○	○	○	○	○	○	—	—	—	—
	Left	—	—	○	○	○	○	○	○	○	○	○	○	○	○	○	—	—	—	—

Accessories



Black/Gold



White/Silver



		20.0	21.0	22.0	22.5	23.0	23.5	24.0	24.5	25.0	25.5	26.0	26.5	27.0	27.5	28.0	28.5	29.0	29.5	30.0	31.0	32.0	
Right & Left	Black/Gold	—	—	—	○	○	○	○	○	○	○	○	○	○	○	○	○	○	○	—	○	※	※
	White/Silver	—	—	—	○	○	○	○	○	○	○	○	○	○	○	○	○	○	○	—	○	※	※



ABS CLASSIC

Materials : Leather,TPU,Velcro

Accessories



Options



SHOES



Black / Black



White / Silver

SIZE
EE
SIZE



KANGAROO SHOES



NV-3

Materials: Kangaroo Leather,
EVA, Rubber, Velcro

		20.0	21.0	22.0	22.5	23.0	23.5	24.0	24.5	25.0	25.5	26.0	26.5	27.0	27.5	28.0	28.5	29.0	29.5	30.0
Black/Black	Right	—	—	○	○	○	○	○	○	○	○	○	○	○	○	○	—	—	—	—
	Left	—	—	○	○	○	○	○	○	○	○	○	○	○	○	○	—	—	—	—
White/Silver	Right	—	—	○	○	○	○	○	○	○	○	○	○	○	○	○	—	—	—	—
	Left	—	—	○	○	○	○	○	○	○	○	○	○	○	○	○	—	—	—	—

Accessories



Black



White

WIDE
EEE
SIZE

Right
Only



S-1500W

Materials: Fine Microfiber, Soft EVA, Velcro

		20.0	21.0	22.0	22.5	23.0	23.5	24.0	24.5	25.0	25.5	26.0	26.5	27.0	27.5	28.0	28.5	29.0	29.5	30.0
Right only	Black	—	—	○	○	○	○	○	○	○	○	○	○	○	○	○	—	○	—	○
	White	—	—	○	○	○	○	○	○	○	○	○	○	○	○	○	—	—	—	—

Accessories





Black / Silver



White / Silver

SIZE
EE
SIZE



		20.0	21.0	22.0	22.5	23.0	23.5	24.0	24.5	25.0	25.5	26.0	26.5	27.0	27.5	28.0	28.5	29.0	29.5	30.0	
Right & Left	Black/Silver	—	—	—	—	—	—	—	—	—	—	—	—	—	—	—	—	—	—	—	—
	White/Silver	—	—	○	○	○	○	○	○	○	○	○	○	○	○	○	○	○	○	○	○

ABS
D.I.Y.

S-1230

Materials: Fine Microfiber, Soft EVA, Velcro

Accessories



Black/Silver



White/Silver



Black/Black



Black/Wine

SIZE
EE
SIZE



		20.0	21.0	22.0	22.5	23.0	23.5	24.0	24.5	25.0	25.5	26.0	26.5	27.0	27.5	28.0	28.5	29.0	29.5	30.0	
Right & Left	Black/Black	—	—	○	○	○	○	○	○	○	○	○	○	○	○	○	○	○	○	○	○
	White/Silver	—	—	○	○	○	○	○	○	○	○	○	○	○	○	○	○	○	○	○	○
	Black/Silver	—	—	—	—	—	—	—	—	—	—	—	—	—	—	—	—	—	—	—	—
	Black/Wine	—	—	○	○	○	○	○	○	○	○	○	○	○	○	○	○	○	○	○	○

ABS
D.I.Y.

S-950

Materials: PU, PU Enamel, Soft EVA, Velcro

Accessories



SHOES



Black / Wine



White / Silver



Black / Silver



Black / Black

SIZE
EE
SIZE



		20.0	21.0	22.0	22.5	23.0	23.5	24.0	24.5	25.0	25.5	26.0	26.5	27.0	27.5	28.0	28.5	29.0	29.5	30.0	
Right & Left	Black/Black	—	—	○	○	○	○	○	○	○	○	○	○	○	○	○	○	—	○	—	○
	White/Silver	—	—	○	○	○	○	○	○	○	○	○	○	○	○	○	○	—	—	—	—
	Black/Silver	—	—	—	—	—	—	—	○	○	○	○	○	○	○	○	○	—	—	—	—
	Black/Wine	—	—	○	○	○	○	○	○	○	—	—	—	—	—	—	—	—	—	—	—

Accessories



S-570

Materials : PU, PU Enamel, EVA, Velcro



Felt



Micro Leather



Rubber



Black/Orange



White/Red



Black/Blue



Black/Red

SIZE
EEE
SIZE

Right
only



NEW



S-390

Materials : PU, PU Enamel, EVA

		20.0	21.0	22.0	22.5	23.0	23.5	24.0	24.5	25.0	25.5	26.0	26.5	27.0	27.5	28.0	28.5	29.0	29.5	30.0
Right only	Black/Blue	—	—	—	—	—	—	—	○	○	○	○	○	○	○	○	—	○	—	○
	Black/Red	—	—	○	○	○	○	○	○	○	○	○	○	○	○	○	—	—	—	—
	Black/Orange	—	—	○	○	○	○	○	○	○	○	○	○	○	○	○	—	—	—	—
	White/Red	—	—	○	○	○	○	○	○	○	—	—	—	—	—	—	—	—	—	—



① White / Black



② White / Red



④ Black / Silver



⑤ White / Pink



③ Gray / Dark Gray



⑥ Black / Dark Brown



⑦ Black / Bronze



⑧ Black / Red

SIZE
EE
SIZE



		20.0	21.0	22.0	22.5	23.0	23.5	24.0	24.5	25.0	25.5	26.0	26.5	27.0	27.5	28.0	28.5	29.0	29.5	30.0	
① White / Black	Right	○	○	○	○	○	○	○	○	○	○	○	○	○	○	○	○	○	○	○	○
	Left	—	—	○	○	○	○	○	○	○	○	○	○	○	○	○	○	○	○	○	○
② White / Red	Right	—	—	○	○	○	○	○	○	○	▲	▲	▲	▲	▲	▲	—	—	—	—	—
	Left	—	—	○	○	○	○	○	○	○	▲	▲	▲	▲	▲	▲	—	—	—	—	—
③ Gray / Dark Gray	Right	—	—	▲	▲	▲	▲	▲	○	○	○	○	○	○	○	○	—	—	—	—	—
	Left	—	—	▲	▲	▲	▲	▲	○	○	○	○	○	○	○	○	—	—	—	—	—
④ Black / Silver	Right	—	—	▲	▲	▲	▲	▲	○	○	○	○	○	○	○	○	—	—	—	—	—
	Left	—	—	▲	▲	▲	▲	▲	○	○	○	○	○	○	○	○	—	—	—	—	—
⑤ White / Pink	Right	—	—	○	○	○	○	○	○	○	—	—	—	—	—	—	—	—	—	—	—
	Left	—	—	○	○	○	○	○	○	○	—	—	—	—	—	—	—	—	—	—	—
⑥ Black / Dark Brown	Right	—	—	—	—	—	—	—	○	○	○	○	○	○	○	○	—	—	—	—	—
	Left	—	—	—	—	—	—	—	▲	▲	▲	▲	▲	▲	▲	▲	—	—	—	—	—
⑦ Black / Bronze	Right	○	○	○	○	○	○	○	○	○	○	○	○	○	○	○	—	—	—	—	—
	Left	○	○	○	○	○	○	○	○	○	○	○	○	○	○	○	—	—	—	—	—

▲limited stock



S-380

Materials : PU, PU mid-sole, Felt, Rubber



Gray / Gray



White / Aqua Blue



White / Pink



Black / Black



White / Silver

SIZE
EE
SIZE



		20.0	21.0	22.0	22.5	23.0	23.5	24.0	24.5	25.0	25.5	26.0	26.5	27.0	27.5	28.0	28.5	29.0	29.5	30.0	
White / Silver	Right	○	○	○	○	○	○	○	○	○	○	○	○	○	○	○	—	—	—	—	—
	Left	○	○	○	○	○	○	○	○	○	○	○	○	○	○	○	—	—	—	—	—
Black / Black	Right	—	—	○	○	○	○	○	○	○	○	○	○	○	○	○	—	—	—	—	—
	Left	—	—	○	○	○	○	○	○	○	○	○	○	○	○	○	—	—	—	—	—
White / Aqua Blue	Right	—	—	○	○	○	○	○	○	○	—	—	—	—	—	—	—	—	—	—	—
	Left	—	—	○	○	○	○	○	○	○	—	—	—	—	—	—	—	—	—	—	—
White / Pink	Right	—	—	○	○	○	○	○	○	○	—	—	—	—	—	—	—	—	—	—	—
	Left	—	—	○	○	○	○	○	○	○	—	—	—	—	—	—	—	—	—	—	—
Gray / Gray	Right	—	—	○	○	○	○	○	○	○	○	○	○	○	○	○	—	—	—	—	—
	Left	—	—	○	○	○	○	○	○	○	○	○	○	○	○	○	—	—	—	—	—



S-250 (ENTRY LEVEL)

Materials : PU

SHOES



Shoes DIY Parts

For NV-4/CLASSIC/NV-3

S-1500W/S-1230/S-950/S-570 他

D.I.Y. Slide Parts

Velcro Lined.
Cut to the sole of
your shoe.



1 Teflon
90×130mm



2 Felt
180×130mm



3 Chrome Leather
180×130mm



4 Deer Skin
180×130mm



Micro Leather
180×130mm



6 Back Skin
180×130mm



7 Oiled Nu-buck
180×130mm

More Slide

Less Slide

D.I.Y. CLASSIC Parts

S 22.5 ~ 24.0 L 25.5 ~ 26.0 3L 27.5 ~ 29.0
M 24.5 ~ 25.0 LL 26.5 ~ 27.0

Velcro lined.



Special Rubber



Blue

More Slide



Yellow

70°



Red

55°

Less Slide

D.I.Y. Cleat Type Slide Parts for NV-3

Velcro lined.
Use with Slide Cleats.

S 22.0 ~ 23.0 M 23.5 ~ 24.5 (cm) holes

6

L 25.0 ~ 26.5 LL 27.0 ~ 28.0 (cm) holes

7



2 Felt

More Slide



3 Chrome Leather



4 Deer Skin



6 Back Skin



7 Oiled Nu-buck

Less Slide

D.I.Y. Cleat Type Slide Parts for NV-4

Velcro lined.
Use with Slide Cleats.

S 22.0 ~ 23.0 M 23.5 ~ 24.5 (cm) holes

5

L 25.0 ~ 26.5 LL 27.0 ~ 28.0 (cm) holes

6



2 Felt

More Slide



3 Chrome Leather



4 Deer Skin



6 Back Skin



7 Oiled Nu-buck

Less Slide

D.I.Y. Slide Cleats

Velcro lined. Set of 7 pcs. Use with Cleat Type Slide Bases.



1 Teflon

More Slide



2 Felt



3 Chrome Leather



4 Deer Skin



6 Back Skin



7 Oiled Nu-buck

Less Slide

D.I.Y. Slide Heels

Velcro lined.



1 Flat Hard

More Slide



2 Flat Normal



3 Groove Soft



4 Wave Soft



5 Back Skin



7 Oiled Nu-buck

Less Slide

(cm)
S 22.0 ~ 22.5
M 23.0 ~ 24.5
L 25.0 ~ 26.5
LL 27.0 ~ 28.0



More Slide



2



3



4



5

Less Slide

TRICOLOR

(cm)
S 22.0 ~ 24.5
M 25.0 ~ 26.5
L 27.0 ~ 28.0
LL 29.0 ~ 30.0

Kick Parts



Rubber

D.I.Y. Toe Cap w/ Kevlar

Left or right.

(cm)
S 22.0 ~ 23.5
M 24.0 ~ 25.5
L 26.0 ~ 27.5
LL 28.0 ~ 30.0



Velcro lined.



Glue not included.

D.I.Y. Kick Heel

Velcro lined.

(cm)
S 22.0 ~ 22.5
M 23.0 ~ 24.5
L 25.0 ~ 26.5
LL 27.0 ~ 28.0



D.I.Y. Rubber for NV-KID

22.0-22.5 / 23.0-23.5 / 24.0-24.5
25.0-25.5 / 26.0-26.5 / 27.0-27.5
28.0- (7sizes)



Shoe Bag

390×330mm



GLOVES



Speed Dialer

Allows for a 3 way adjustment for quick changes on the lane. Simply turn the dialer clockwise to the required position. Adjustments can be as small as 1/10 of a millimeter.

ATS

Bellow the Axis Tilt (Right/Left angle) position adjustment for use in setting the Axis Tilt.

Velcro Wrist Belt

The super soft, thin, durable, high quality leather belt. Easily set by hook & loop fastener.

ABS Robo Wrist®

(Japan PAT. 3259841)

Materials: Super light weight, Heavy duty, Reinforced duralumin.

Features: Finger and wrist support.



Finger Support

One touch detachable finger tip (EVA Rubber is 2.5mm thick for added support).

Velcro Palm Belt

Hook and loop fasteners on both sides allow the belt to be adjusted to fit the palm perfectly. Super soft, thin and durable.

The spring acts as a lock to ensure the setting.



ABS Robo Wrist® Gold Finger (Right hand only)

Materials: Super light weight, Heavy duty, Stainless steel.

Features: Finger and wrist support.

Small W100×D50×H250mm 312g
Regular W100×D50×H290mm 337g
Large W100×D50×H290mm 347g



Black/Silver

Wine Red



FLAT!

The flat top allows for more finger movement.

SHORT!

New compact body allows for more release options.

ONE SIDE!

Single sided wing provides added flexibility.



Gun Metallic

Pearl White

Pearl Pink

ABS Robo Wrist® Short Model

(Japan PAT. 3259841)

Materials: Super light weight, Heavy duty, Reinforced duralumin.

Features: Compact and wrist support.



OPTION



ABS Replacement Palm belt for Gold Finger (Right hand only)

Size : Small : 22cm , Regular : 23cm , Large : 25cm

ABS Replacement Palm belt Easy use velcro

Size : Small : 28 cm
Regular : 30 cm
Large : 33 cm (Right hand only)

ABS Replacement Wrist belt Easy use velcro

Size : Small : 30 cm
Regular : 32 cm
Large : 35 cm

Specs	Hand	Stainless	Wine Red	Black/Silver	Pink	Gun Metallic	Pearl White
Small W100×D50×H250mm 235g Stainless 275g	R	●	●	●	×	×	×
	L	×	●	●	×	×	×
Regular W100×D50×H290mm 265g Stainless 300g	R	●	●	●	×	×	×
	L	●	●	●	×	×	×
Large W100×D50×H290mm 265g Stainless 310g	R	●	●	●	×	×	×
	L	×	×	×	×	×	×
Short Model: Small W100×D50×H220mm 210g	R	×	×	×	●	●	●
	L	×	×	×	×	×	×
Short Model: Regular W100×D50×H250mm 230g	R	×	×	×	●	●	●
	L	×	×	×	×	×	×
Gold Finger: Small/Regular/Large	R	●	×	×	×	×	×
	L	×	×	×	×	×	×

GLOVES



Purple



Black



Blue



Red



White



Mongoose

Sizes : S, M, L (R/L)

Materials : Polyester, Aluminum Plate

Features : Finger and Wrist support. *-Not available for U.S.A.*



Red/ Black



Black/ Black



Blue/Black



Purple/ Black



Multi Wrist

Sizes : S, M, L (R/L)

Materials : Polyester Knit Mesh, Aluminum Plate

Features : Finger and wrist support with special silicon rubber.



Blue/Black



Black/ Black



Red/ Black



Purple/ Black



Finger Support

Sizes : Sizes S, M, L (R/L)

Materials : Polyester Knit Mesh, Aluminum Plate

Features : Finger and wrist support.



Purple/ Black



Black/ Black



Blue/Black



Red/ Black



Ultra Wrist

Sizes : S, M, L (R/L)

Materials : Polyester Knit Mesh, Aluminum Plate

Features : Finger and wrist support.



Blackberry

Raspberry

ABS Pro Wrist

Sizes : XS, S, M, L, XL (R/L)
 Materials : Soft PU, Aluminum Plate
 Features : Compact wrist support.



Black/ Black

Blue/Black



Red/ Black



Purple/ Black

ABS Super Wrist

Sizes : S, M, L (R/L)
 Materials : Polyester Knit Mesh, Aluminum Plate
 Features : Wrist support.



Red

Orange



ABS Mini Wrist

Sizes : S, M, L (R/L)
 Materials : Polyester Knit Mesh, Aluminum Plate
 Features : Wrist support.

Black



Black



Blue



Red



Red

Black (R/L) Purple



ABS Tacky Palm

Sizes : XS, S, M, L, XL (R/L)
 XXS(only Black)
 Materials : Special Silicon Rubber
 Features : For maximum grip.

ABS Super Tacky Palm

Sizes : 18(XXS), 19, 20(XS), 21, 22(S), 23(M), 24, 25(L), 26(XL)
 Right Only (Black : R/L)
 Materials : Special Silicon Rubber
 Features : For maximum grip.

Cream



Black



Blue



Wrist Master 2

Sizes : S, M, L (R/L)
 Materials : PU, Aluminum Plate
 Features : Wrist support.



Dr. Elbow

Sizes : SS (22-23cm), S (24-25cm),
 M (26-27cm), L (28-30cm), LL (31-34cm)
 Features : Prevents tendonitis.



ABS Palm Supporter

U/I : 12 pcs. Sizes : one sizes fits all
 Materials : 70% Polypropylene, 17% Rayon
 Features : Gives a firm fit with added padding for maximum comfort. Use alone or with other ABS gloves for added support.



ABS Glove Liner

U/I : 12 pcs.
 Sizes : one sizes fits all
 Materials : 100% Cotton
 Features : For maximum comfort and absorption of perspiration. Use alone or with other ABS gloves for added support and comfort.



TAPES



ABS Fitting Tape F-1 25

U/I : 12 pcs.
Dimensions : 25mm × 4M



ABS Fitting Tape F-1 50

U/I : 6 pcs.
Dimensions : 50mm × 4M

Features : Cotton thin tape. Protects fingers.



ABS Fitting Tape F-2 25

U/I : 12 pcs.
Dimensions : 25mm × 4M



ABS Fitting Tape F-2 35

U/I : 6 pcs.
Dimensions : 35mm × 4M



ABS Fitting Tape F-2 50

U/I : 6 pcs.
Dimensions : 50mm × 4M

Features : Sweat proof. Cotton.
Very smooth surface. Protects fingers from cuts.



ABS Fitting Tape F-3N 25

U/I : 12 pcs.
Dimensions : 25mm × 4M



ABS Fitting Tape F-3N 50

U/I : 6 pcs.
Dimensions : 50mm × 4M

Features : Rough texture gives adhesiveness to its surface and provides maximum grip.



ABS Fitting Tape F-4 25

U/I : 12 pcs.
Dimensions : 25mm × 4M



ABS Fitting Tape F-4 50

U/I : 6 pcs.
Dimensions : 50mm × 4M

Features : Strong adhesion and easy to remove from fingers.



Black

White

ABS ABS Brand Tape

U/I : 12 pcs.
Dimensions : 25mm × 4M



Basic Taping Methods



Taping methods for Fitting Tapes, Skin Tapes, Patch Tapes, and Grip tapes.

Round the corners to prevent from peeling off.

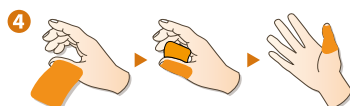
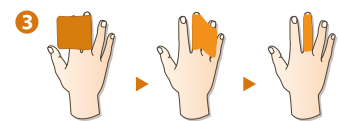
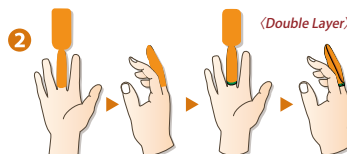
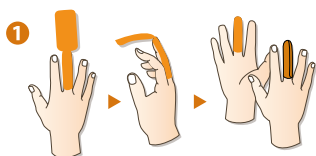



25mm×5M : Beige 50mm×5M : Beige

Kinesio Tape

(Breathable Elastic.)
 U/I : 25mm:Box of 12 rolls.
 50mm:Box of 6 rolls.
 Materials : Elastic, Adhesive Cotton



White 25mm×5M
 50mm×5M Beige

Hilate Tape

U/I : 25mm:12 rolls ea. 50mm:6 rolls ea.
 Materials : Elastic, Adhesive Gauze
 Features : Prevents blisters, sores, and cuts.



Stik Tape

U/I : Display box of 24 rolls ea.
 Features : For adjusting finger hole size.

Set Position A·B



Non-slip Silicon Tape

U/I : 24 packs (5 pcs ea.)
 Features : Elastic, Silicone, Adhesive cotton

Set Position A



Timing Tape

U/I : Box of 12pkgs (48pcs ea)
 Dimensions : 25mm×70mm
 Friction Level : Low(Red) Medium(Blue) High(Black)



Thumb Insert IT-1

U/I : Box of 12 pkgs (12 pcs ea.)
 Dimensions : 19×50 mm
 Materials : Teflon
 Features : Adjusts for a smoother, faster, and cleaner release.

Set Position B



High Quality Insert Tape

U/I : 12 packs (30 pcs ea.)
 Sizes : 1", 1/2", 3/4"
 Features : Adjusts thumb hole.

Set Position A

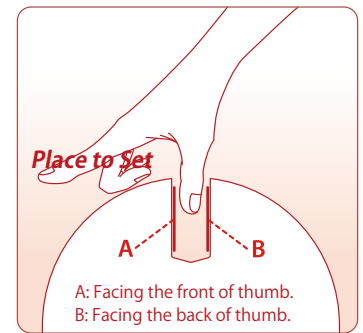

Thumb Cushion

U/I : 24 packs (2 pcs ea.)
 Sizes : 1 size
 Features : For maximum grip.

Set Position B



Insert Tape (by USA Master)

U/I : 24 packs
 Sizes : 1", 1/2", 3/4"
 Features : Adjusts thumb hole.

Set Position A



Insert Tape Super Textured (by USA Master)

U/I : 12 packs
 Sizes : 3/4"
 Features : Adjusts thumb hole.

Set Position A



Set Position A



Set Position B



Set Position B



Set Position B

Turbo Shur Hook Cork Tape

U/I : 40 packs
 Features : For better hook control and release.

Turbo Shur Out Tape Strips

U/I : 40 packs
 Features : For quick clean release.

Turbo Shur Cushions (1/8)

U/I : 20 packs
 Features : For the perfect fit.

Turbo Shur Cushions (1/4)

U/I : 20 packs
 Features : For the perfect fit.

ACCESSORIES

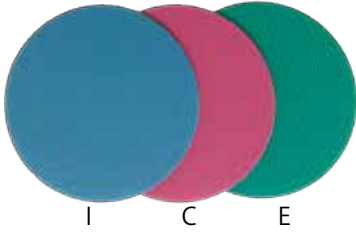

ICE Sanding Pad

Discontinued item / limited stock

U/I : Box of 6 ea.

Features : 900 Global exclusively recommended sanding pads.

Available in (I) #1500, (C) #2000, (E) #3000

Abralon

Made in Finland

Abralon is superior sanding and polishing product for bowling ball surface applications. Used to achieve extremely fine polished surfaces with minimal effort.

ABS Abralon

U/I : Box of 6 ea.

Features : Highly effective oil removing pad.
Compact size fits right in bowlers hands.

Available in 180, 360, 500, 800, 1000, 1500, 2000, 3000 and 4000 grit.



Hand Conditioner

U/I : Box of 12 ea.

Features : Keep hands dry providing continuous control.



Rosin Bag

U/I : Box of 12 ea.

Features : Provides extra grip even on the most humid days.



Master Rosin

U/I : Box of 12 ea.

Features : Get a grip with compact rosin bags.



Puff Ball

U/I : Box of 12 ea.

Features : Keep hands dry and in control.



Skin Patch

U/I : Box of 24 ea.

Net. : 1/4 oz (7.4ml)

Features : Liquid bandage to protect fingers & nails.



Giant Skin Patch

U/I : Box of 24 ea.

Net. : 3/4 oz (22.2ml)

Features : Liquid bandage to protect fingers & nails.



Ultra Bond

U/I : 6 units

Net. : 50g (approx.1.76 oz)

Features : Versatile adhesive for inserts.

Shoe Slide

U/I : Display box of 20 pkgs ea.

Features : Elastic, silicone, Adhesive cotton.



Approach Powder

U/I : Box of 12 ea.

Features : Increases a bowler's approach slide.



Finger Grip Remover

U/I : 63/64, 7/8

Features : Removes finger inserts.



Bevel knife

U/I : 6 units

Features : To adjust hole size.

Full length 200mm, Blade length 70mm
Blade width 9mm (Maximum part)



Wire Brush (by KR)

U/I : Box of 6 ea.

Features : Removes dust and dirt from shoe soles.

ABS Brand Name Leather Pad

U/I : 12 pcs.
 Features : Highly effective oil removing pad.
 Compact size fits right in bowlers hand



ABS Shoe Cover

U/I : 12 pairs.
 Features : Protects your shoes off the lane.
 Size : M (~24.5 cm)
 L (25.0cm~27.5 cm)
 LL (28.0 cm~)



ABS Microfiber Towel

U/I : 12 pcs.

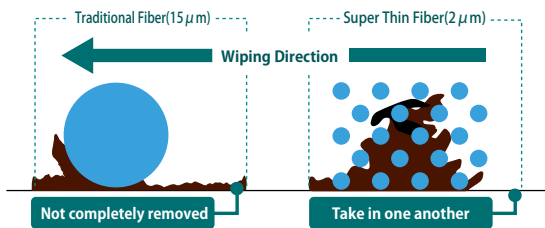

Traditional fiber spreads oil and dust but cannot completely remove it. Super thin fiber gets closer to the surface and wipes up and traps the dirt and oil into the space in between the fibers (inner trap function).

ABS Autograph Book

Ideal for collecting Pro Bowler's autographs.
 U/I: 1 set / 6 books per set
 Size: 160mm x 110mm / 22 pages
 Colors: Red/ Blue/Yellow
 (1 color per set)

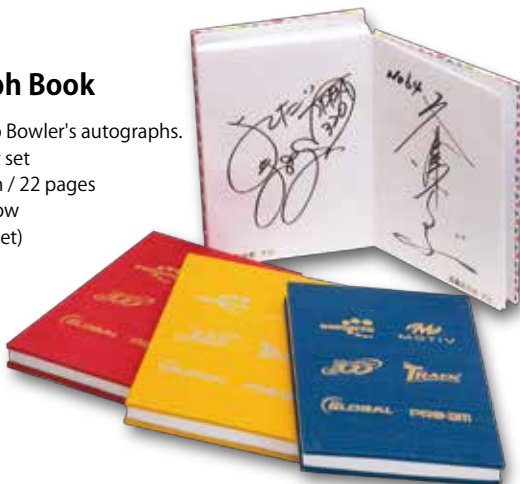

ABS Socks 300

U/I : 120 pairs.
 Materials : Cotton, Polyester
 Features : Mesh top, for added ventilation



ABS Socks 200

U/I : 120 pairs.
 Materials : Cotton, Polyester
 Features : Lightweight and absorbent



ABS Kids Socks

U/I : 12 pairs.
 Materials : Cotton, Polyester



ACCESSORIES

Oil Removal Cleaner

ION POWER S



Made in Japan

ION POWER S effectively removes oil and dirt from the surface of bowling balls on contact.

This water soluble cleaner contains strong working alkaline ion water for powerful oil and dirt absorption that helps revives ball performance.



Ion power S Spray

U/I : 1 case / 24 bottles (100ml)
1 case / 12 bottles (200ml)

Ion power S Foam

U/I : 1 case / 12 bottles

Ion power S Refill

U/I : 1 case / 12 bottles



Spray (100ml)

Spray (200ml)

Foam (200ml)

Refill (500ml)

Ion power S Wiping Cloth

U/I : 1 case / 12 units
Sheet size : 200×200mm



Ion power S Gel Pack

NEW

U/I : 1 case / 12 units
(4 packs per bag)

Covering the ball with the Ion Power S Gel Pack is effective in removing oil and dirt. For use before or after bowling. This product is flammable and caution must be taken not to use near an open flame.



How to use

<p>Remove from bag. (2 pieces in 1 bag)</p>	<p>Spread the ((GEL PAC)) with the folds on the left and right.</p>	<p>Cover the ball with ((GEL PAC))</p>
<p>Cover the open area with remaining ((GEL PAC))</p>	<p>Wait about 15 minutes, then remove the ((GEL PAC))</p>	<p>To finish, wipe off the oil and dirt on the surface of the ball with a commercially available ball cleaner.</p>

"QR code": instructional video



ABSOLUTE BALL WIPER



- Pre-moistened with detergent for powerful cleaning on contact.
- Durably made and torn resistant.
- Unscented deodorization.
- Easy to carry in compact pouch.
- Environmentally friendly and soft on hands.
- Nonflammable.

ABSOLUTE Ball Wiper

U/I : 1 case / 24 units
Sheet size : 170×200mm



Made in Japan

ABSOLUTE QUICK WIPER



Made in Japan



ABSOLUTE Quick Wiper

U/I : 1 case / 10 units
Sheet size : 170×215mm



ABSOLUTE Cleaner

ABSOLUTE Cleaner removes lane oil and dirt from the ball's surface.

U/I : 12 units (200ml)



Made in Japan



ABSOLUTE Remover

ABSOLUTE Remover revives the bowling ball to its original condition by removing oil that has soaked into the coverstock and dirt / grime from the ball's surface.

U/I : 12 units (200ml)



Made in Japan



ABSOLUTE Remover mousse type

ABSOLUTE Cleaner removes lane oil and dirt from the ball's surface.

U/I : 12 units (235ml)



Made in Japan



Bowl Clean

U/I : 12 units (180ml)
Features : Removes stubborn dirt preventing deterioration.



Made in Japan



Kegel Revive

U/I : 12 units (236ml)
Features : Cleans and maintains ball surface. Limits oil absorption and reduces dirt buildup. Increasing performance and longevity.

DRILL MACHINE

ABS Hydraulic Drilling Machine

High Quality Researched, Developed, Manufactured and Constructed in Japan.



Made in Japan

World's First Increased grip capability with Hydraulic clamping! By holding the ball in a fixed position, the instability during drilling through different mass, and for double hole drilling is dramatically improved.

Increased Control Zero control can be adjusted easily with Laser Assist and minor adjustments to a drilling position (i.e. Grip Center).

Machine Characteristics

ABS Hydraulic Clamping System

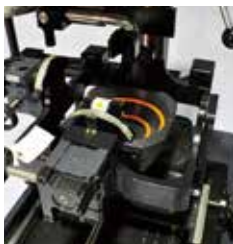

Keeps the drill area free, with a tight hold

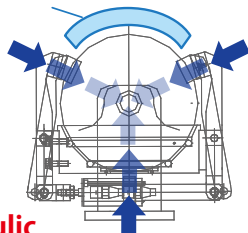

World's first hydraulic clamping system for bowling balls.



Instable ball clamps cause inaccurate drilling.

Unstable ball while drilling can result in a larger hole and a rough drill surface.



Hydraulic Clamping System

A smooth drilling, with a clean drill surface.



Laser Light Assist.



Uses a LM Guide to assist the driller (assistance on x and y co-ordinates)

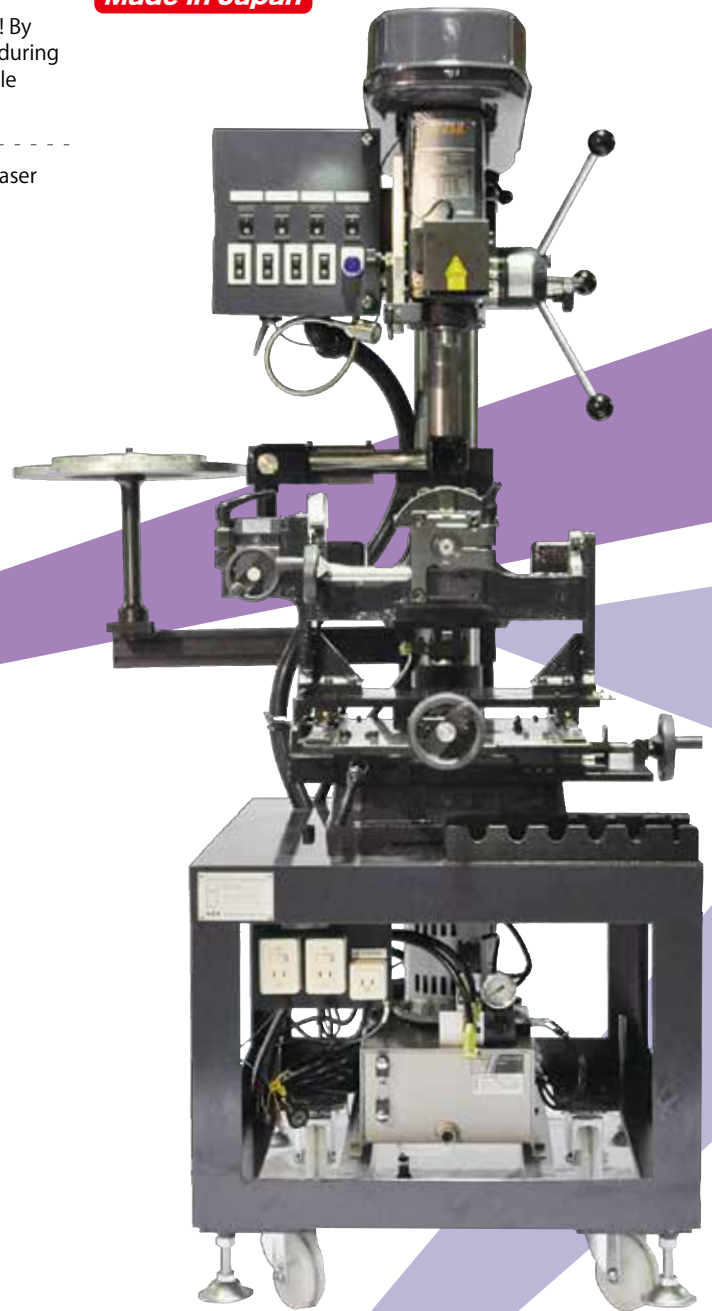

ABS ABS Hydraulic Drilling Machine

Quantity : 1 machine

Size : H1751×W650×D850 (excluding drill-bit tray)

Weight : 380kg

Power Supply : AC100V

Energy Consumption : 50Hz 30A, 60Hz 29A (Including 14A Vacuum)

Accessories : Series of Drill Bits (Made in Japan) Drill Bit Removal Tool
Center Removal Tool Instruction Manual
Vacuum

Additional Options

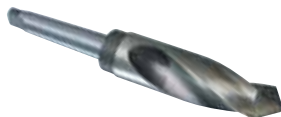

ABS Drill Bits (Made in Japan)

Quantity : 1 Bit

Sizes : 1 1/4" , 1 1/8" , 63/64" , 31/32" , 7/8"



Digital Scale System

Digitally display for forward/reverse, and left/right pitches and drill depth can be added.

Enabling for more precision in your drilling.

Scales can be set in inches, millimeters or fractions.

Fractions can be set displayed in 1/16, 1/32 and 1/64.

Parallel XY pitch and Z Pitch sensor + Magnetic Tape.

Please Note: This system can only be applied after calibration of the machine. It cannot be applied before shipment.

BALL CLINIC Bowling Ball Maintenance.

Our ball resurfacing machine, BALL CLINIC, will sand and polish balls to almost any surface the user wishes. A quick process which also removes the risk of uneven sanding. The embedded Ball Refresh full course, will remove ball track and scratches. The removal of scratches will depend on their depth.

Renewal!

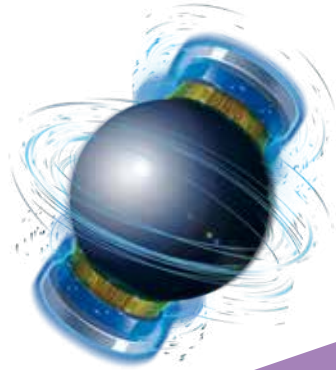

Made in Japan

Ball Maintenance with the ease of a Vending Machine

- Fully compatible with house balls.
- Cleans the surface of dulled balls.
- Attractive and appealing to bowlers.

ABS BALL CLINIC

Quantity : 1 Machine
 Size : H1350×W800×D720 mm
 Weight : 210 kg
 Power : Supply AC100V
 Current : Max. 13A (Ave. 8A)
 Accessories : Clean Brush, Green Mesh, Fine Mesh,
 Yellow Diamond Sheet, Grip Roller



Ball Clinic Accessories



3M Finishing Compound
 U/I : 1 gallon



Clean Brush
 U/I : 1 Brush



Yellow Diamond Sheet
 U/I : 1 Pad

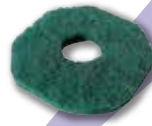

Green Mesh Pad
 U/I : 1 Set of 5 Pads



Fine Mesh Strips
 U/I : 1 Set of 15



Grip Rollers
 U/I : 1 Set of 4 Rollers

DRILL MACHINE

ION POWER OIL REMOVER

ION POWER OIL REMOVER

Quantity : 1 Machine
 Size : H350×W480×D350 mm
 Weight : 4.0kg
 Power : Supply AC100V 1A



Revive your ball!

Options

ION POWER 1500

U/I : 1 Box (20L)



ION POWER 2000

U/I : 1 Box (20L)



Cleaning Effect of strong alkaline ion water

Soap Effect

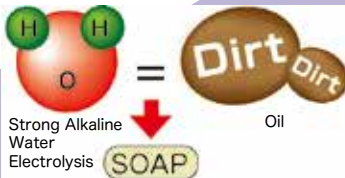

Alkaline ion water contains properties which help dissolve dirt, creating a detergent like effect on stubborn oil and debris.

Absorption and Osmotic Swelling Effects

The Strong alkaline ion water efficiently absorbs and pulls dirt and oil to the surface of the bowling ball.



Separation Effects

The negative ion in the alkaline ion water absorbs the positive ions in the oil and dirt; and separates the debris from the surface of the bowling ball.



Emulsion and Dispersion Effects

The strong alkaline ion water disperses and emulsifies the oil and dirt, for efficient cleaning.



ABS Plug Cutter

Light & Easy to use

POWER

- Quiet and powerful 4.4 AMP motor for improved performance. No load speed of 26,000 RPM for ultra-smooth cutting.
- Electronic speed control maintains constant speed under load.

COMFORT

- Simple and efficient base lock system securely fastens the base and increases productivity.
- Thumb roller for fine cutting depth adjustment.
- Ergonomic, slim (2-3/8") body style for comfort and control.
- Soft start feature for smooth start-ups.

ACCURATE

- Built-in shock-proof, high output, white L.E.D. light illuminates cutting edge and increases visibility with a bulb that never needs replacing throughout the life of the tool.

DURABILITY

- Tough Polycarbonate clear cover for long lasting protection.



Quick Release Clamp



Vacuum Hose Adaptor



Convenient Power Switch



LED Lights

PROSHOP EQUIPMENT



Ball Spinner

U/I : 1 unit
 Features : High-performance and low-cost polishing machine.
 Motor : 0.2HP, 100V 50/60Hz

•Available by order



Made in Japan



Measuring Ball (by USA Jayhawk)

U/I : 1 unit
 Features : Scales the span, hole sizes, and pitch.

•Available by order



The Determinator (by USA Jayhawk)

U/I : 1 unit
 Features : Detect the Mass Bias and spin time.



Holtzman Ball Balance Scale (by USA Jayhawk)

U/I : 1 unit



Hand Grinder (by KR)

U/I : 1 unit
 Features : Use with sanding discs for sanding holes.
 Includes : 50(#120)sanding discs.



Hand Grinder (by KR)

U/I : 1 unit
 Features : Use with sanding discs for sanding holes.
 Includes : 10(#80)sanding discs.

Sanding Discs(#120)

U/I : 100pcs.
 Features : Use with Master Hand grinder.



Discontinued item /limited stock



HD, HR Custom Color Kit

U/I: Set of 12 (3/4 oz per bottle)
 Features: Full Line-up of colors.



ABS Plug Color

U/I: 1 bottle (2 oz per bottle)
 Features: Great deal at a reasonable price.



HR Plug Kit

U/I: 1 set (1/2 gal. per bottle)
 Features: Set of 1 bottle of hardener and 3 of compound.

Also sold separately in single bottles.



HD, HR Pump Kit

U/I: 1 set (2 pumps)



Ball Fitter Original

U/I: 1 gauge
 Features: Accurately measures the hole sizes, span, the side pitch of thumb hole.

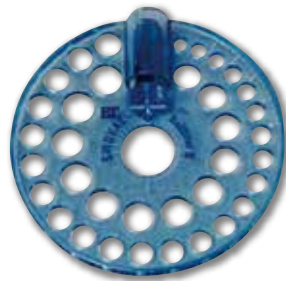

Ball Fitter Swoval

U/I: 1 gauge
 Features: Easy to accurately measure the hole sizes, span, the side pitch of thumb hole.
• Available by order

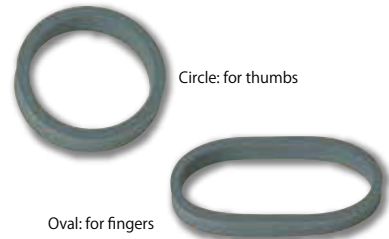

POWER HOUSE Ultra Safe Dams

U/I: Circle: 150 pcs.,
 Oval: 100 pcs.
 Features: Avoids messy clay while plugging.



Pitch Gauge

U/I: 2 gauges (blue & red)
 Features: Measures the pitch after drilling.



Jayhawk Axis Reversing Tool

U/I: 1 gauge
 Features:

- Find a centerline from a bowler's axis point in one easy step!
- Eliminates the need to use a quarter-scale for layouts.
- Create layouts faster, more accurately, and fewer lines.



Turbo Pro Sect

U/I: 1 gauge
 Features:

- Indicates degree of angle for thumb.
- Easy to read ruler spans, full diameter of the ball.
- Assures accurate ball layouts.

PROSHOP EQUIPMENT



Span Gauge

U/I : 1 gauge
 Features : Measures the span in inches.



Yellow Marking Pencils

U/I : 1 dz. (12 pct.)
 Uses : Ball Marking.



ABS Hexagonal Ball Base

U/I : 10pcs.
 Materials : Plastic



ABS Bowl Clean

U/I : 6 bottles
 (1 liter per bottle)
 Features : Removes stubborn dirt preventing deterioration.



Made in Japan



Shoe Refresh

U/I : 24 cans/1box (420ml)
 Features : Anti-bacterial shoe deodorizer.



Made in Japan



Made in Japan

Lane Approach Cleaner(APC-1700M)

Removes dirt and heel marks fast and efficiently
 Water Soluble cleaner
 For use on all approach surfaces
 U/I : 1 case (20L per case)
 ※This is not a stock item and is ordered upon request.



Made in Japan

Approach Cleaner(APC-1B-400)

Removes dirt and heel marks fast and efficiently
 Alcohol-based cleaner dries quickly
 For use on all approach surfaces
 U/I : 1 case (4 bottles)(4L per case)
 ※ This is not a stock item and is ordered upon request.



POWER HOUSE Power Wash

U/I : 1 bottle
 (32oz/946ml per bottle)



POWER HOUSE Magic Shine

U/I : 1 bottle
 (32oz/946ml per bottle)



POWER HOUSE Factory Polish

U/I : 1 bottle
 (32oz/946ml per bottle)



ABS Diamond Compound

U/I : 1 bottle
 (32oz/946ml per bottle)

THUMB SORID



Clear Black
U/I : 10pcs.



Clear Blue
U/I : 10pcs.



Pinky
U/I : 10pcs.



Shinobu Saito



Takeo Sakai



Isao Yamamoto



Mayumi Yoshida



Minute Grip
U/I : 10pcs.



Power-SB
U/I : 10pcs.
Material : Urethane



Ice Grip
U/I : 10pcs.
Material : Urethane



Ice Grip Ladies
U/I : 10pcs.
Material : Urethane

ABS GRIP	outer dia	inner dia: each 1/64																								
		17/32	35/64	9/16	37/64	19/32	39/64	5/8	41/64	21/32	43/64	11/16	45/64	23/32	47/64	3/4	49/64	25/32	51/64	13/16	53/64	27/32	55/64	7/8	29/32	
Clear Black	31/32"	—	—	—	—	○	○	○	○	○	○	○	○	○	○	○	○	○	○	○	○	○	○	○	○	
Clear Blue	31/32"	—	—	—	—	○	○	○	○	○	○	○	○	○	○	○	○	○	○	○	○	○	○	○	○	
Pinky	7/8"	○	○	○	○	○	○	○	○	○	○	○	○	○	○	○	○	○	○	○	○	○	○	○	○	
Minute Grip	1"	—	—	—	—	○	○	○	○	○	○	○	○	○	○	○	○	○	○	○	○	○	○	○	○	
POWER-SB	31/32"	—	—	—	—	○	○	○	○	○	○	○	○	○	○	○	○	○	○	○	○	○*	○*	—	○*	○*
Ice Grip	31/32"	—	—	—	—	○	○	○	○	○	○	○	○	○	○	○	○	○	○	○	○	○*	○*	—	○*	○*
Ice Grip Ladies	7/8"	○	○	○	○	○	○	○	○	○	○	○	○	○	○	○	○	○	○	○	○	○	○	○	○	○

※ outer dia is 1 • 1/32"



White Tip
U/I : 10pcs.



Lady's Tip
U/I : 10pcs.



Semi Cerise / Lady's Semi Cerise
U/I : 10pcs.

	outer dia	inner dia: each 1/32									
		19/32	5/8	21/32	11/16	23/32	3/4	25/32	13/16	27/32	7/8
White Tip	1"	○	○	○	○	○	○	○	○	○	○
Lady's Tip	7/8"	○	○	○	○	○	○	○	○	—	—
Semi Cerise	1"	○	○	○	○	○	○	○	○	○	○
Lady's Semi Cerise	7/8"	○	○	○	○	○	○	○	○	—	—

Solid



Black



Blue



Purple



Orange



Red



White



Yellow



Green



Pink

Half & Half



Red/Green



Blue/Purple



White/Black



White/Pink



Yellow/Orange



Thumb Plug

U/I : 10pcs.
Sizes : 1 1/8", 1 1/4" (Half & Half)
1 3/8", 11/8", 11/4" (Solid Color)



Made in Japan

ABS Thumb Plug

U/I : 10pcs.
Sizes : 1 1/8", 1 1/4"



Black



Blue



Purple



Orange



Pink



White



Clear



Yellow



Green



Red

GRIPS & RAMP & RACK



GRIP LOC



Inner Sleeves



Outer Sleeves



Removal Tool



Depth Gage



Large Outer Sleeves



Drill Stop Ring



Tite Grip Glue

Color	Blue	Gray	Black	Plum	Lime	Fluorescent Blue	Fluorescent Pink	Fluorescent Green	Fluorescent Orange	Fluorescent Yellow
Size	3/4	49/64	25/32	51/64	13/16	53/64	27/32	55/64	7/8	57/64
Color	Fluorescent Red	Fluorescent Purple	Teal	Yellow	Cranberry	Green	Midnight Blue	Red	Orange	White
Size	29/32	59/64	15/16	61/64	31/32	63/64	1	1-1/64	1-1/32	Solid



Made in Japan

Bowl Ramp

Material : polyethylene
 Dimension : 51×28×91cm
 Weight : 5.2kg
 Colors : Blue/ Light Blue/Yellow/Pink/Red



Made in Japan

Ball Rack

For 15/18/21 balls

U/I : 1rack
 Material : Steel (Chrome on surface)
 Notes : Any other specific capacity available.
 Please inquire.



Discontinued item / limited stock



Made in Japan

Ball Rack

For 18 balls

U/I : 1rack
 Material : Steel (Chrome on surface)
 Dimension : 76×136.8×34.5cm



HOUSE BALLS/HOUSE SHOES



Glow under black light.

ABS Urethane Glow House Ball

Material : Urethane
Weight : 5-16 lbs
Notes : Drilling included



ABS Urethane Basket House Ball

Material : Urethane
Weight : 5-16 lbs
Notes : Drilling included



5lbs (5 holes)



5lbs (5 holes)

Available sizes

	14	14.5	15	15.5	16	16.5	17	17.5	18	18.5	19	19.5	20	20.5	21	21.5	22	22.5	23	
Black / Red	○	×	○	×	○	×	○	×	○	○	○	○	○	○	○	○	○	○	○	○
	23.5	24	24.5	25	25.5	26	26.5	27	27.5	28	28.5	29	29.5	30	30.5	31	31.5	32		
Black / Red	○	○	○	○	○	○	○	○	○	○	○	○	○	○	×	○	×	○		

ABS RS-450

Materials : PU synthetic leather/PVC, PU, PU felt, Hard rubber, sponge EVA



Black / Red

Available sizes

	16	16.5	17	17.5	18	18.5	19	19.5	20	20.5	21	21.5	22	22.5	23	23.5	24
Black	○	×	○	×	○	○	○	○	○	○	○	○	○	○	○	○	○
Blue	○	×	○	×	○	○	○	○	○	○	○	○	○	○	○	○	○
	24.5	25	25.5	26	26.5	27	27.5	28	28.5	29	29.5	30	30.5	31	31.5	32	
Black	○	○	○	○	○	○	○	○	○	○	○	○	×	○	×	○	
Blue	○	○	○	○	○	○	○	○	○	○	○	○	×	×	×	×	

ABS RS-420

Materials : PU synthetic leather/PVC, PU, PU felt, Hard rubber, sponge EVA



Black

Blue

Available sizes

	16	16.5	17	17.5	18	18.5	19	19.5	20	20.5	21	21.5	22	22.5	23	23.5	24
Purple	○	×	○	×	○	○	○	○	○	○	○	○	○	○	○	○	○
Blue	○	×	○	×	○	○	○	○	○	○	○	○	○	○	○	○	○
	24.5	25	25.5	26	26.5	27	27.5	28	28.5	29	29.5	30	30.5	31	31.5	32	
Purple	○	○	○	○	○	○	○	○	○	○	○	○	×	×	×	×	
Blue	○	○	○	○	○	○	○	○	○	○	○	○	×	○	×	○	

ABS RS-300

Materials : PU synthetic leather/PVC, PU, PU felt, Hard rubber, sponge Nylon mesh EVA



Purple

Blue

Custom Rental Shoes

Customized rental shoes with your company logo and original design



LOCKER



Made in Japan

Bowling Locker (8-door)

Holds single ball bags.

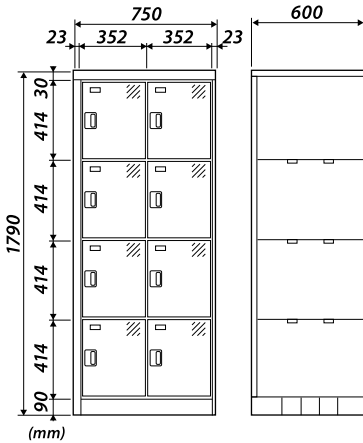

Bowling Locker (6-door)

Holds double ball bags.

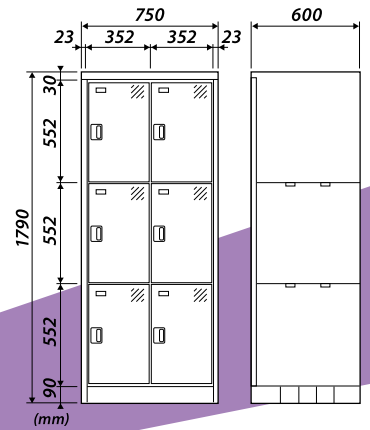

Pick and choose from single, double or triple ball bag cabinets.

Each cabinet holds up to 50kg!

Bowling Locker (4-door)

Holds triple ball bags.
Customize Your Lockers!

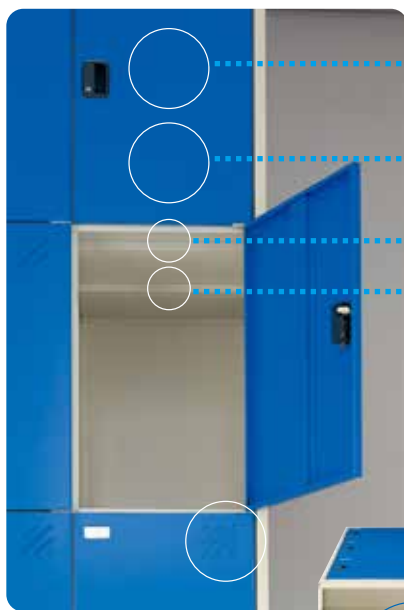
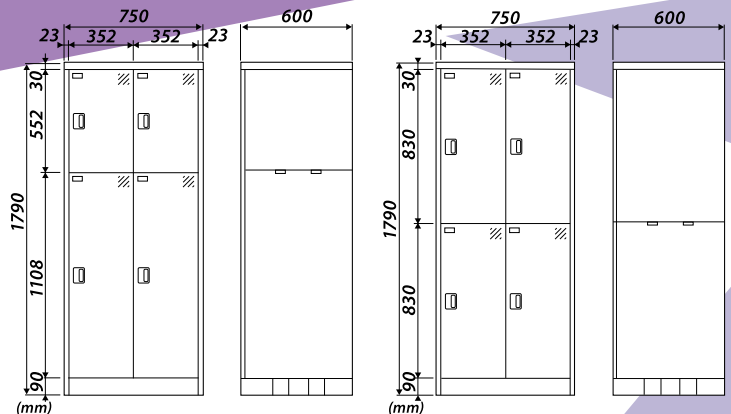

Rust Resistant.

Scratch Resistant.
Melamine resin coated print, for added durability.



The folded plate provides protection from cuts or injury.

Reinforced steel plates.

Air Vents.

Reinforced steel plates to prevent warpage.

Option

Door with Combination Lock



Horizontal

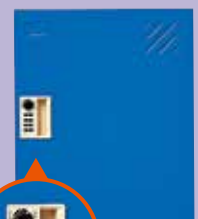

vertical

Kegel Lane Maintenance Machines & Chemicals

ISO 9001

ABS is the exclusive distributor for Kegel products in Japan and the largest worldwide.



KEGEL is the official USBC lane maintenance provider.

IKON High Tech Made Easy



FEATURES

- Sanction Technology™ Conditioning System with forward and reverse capabilities.
- The popular and easy to maintain DUO Transfer System enhances the smoothness of the pattern and allows for easy pattern changes.
- Patented Sprayless Cleaning System - No overspray in the gutters.
- The onboard PLC uses a 3.5 inch color touchscreen which makes it easy to monitor and adjust machine settings.
- The IKON PLC holds 15 patterns of your choice.
- Choose from 3 different size lithium batteries based upon your bowling center's needs or number of lanes ran per day.

TECHNICAL SPECIFICATIONS

- Packaging: One machine per crate
- Part Number:
 - 17-5900 (115V/60 Hz)
 - 17-5950 (230V/50 Hz)
- Weight without the battery: 330 lbs (149.7 Kg)
- Battery Specifications
 - 158-1634 (Red) 25.6 Ah | 24 lbs (10.8 Kg) - Standard
 - 158-1634BU (Orange) 38.4 Ah | 29 lbs (13.1 Kg) - Upgrade
 - 158-1634CU (Yellow) 51.2 Ah | 39 lbs (17.6 Kg) - Upgrade



Batteries

- Each machine comes with our new K2 Energy® lithium battery.
- Upgrade to larger battery based on number of lanes conditioned per day.

* Factory upgrade. (must be installed at time of purchase)
 ** All FLEX Machines come standard with battery 158-1634.



158-1634**
40 lanes



158-1634B
62 lanes



158-1634C
90lanes



FLEX WALKER (BLACK)



FLEX (BLUE)

CONDITIONING

- DUO conditioning system. (two pumps and two conditioner cartridges)
- DUO transfer system.
- Two pre-filled/refillable conditioner cartridges that allow for separate forward and reverse oiling.
- Ability to use two conditioners in one pass.
- Adjustable microliter streams. (per load setting)
- Conditions each lane in less than 90 seconds.
- Conditioner float switches with low level warning message.
- Board-to-board pattern control.
- "Oil Only" function.
- Touchscreen control of oil pump calibration.
- Measure conditioner volume before applying to lane.

TOUCHSCREEN/PLC

- Full color 5" touchscreen display.
- Three programs for both AM and PM.
- Stores 30 programs in memory.
- Test input/output menu option.
- Full detailed error messages with help screens.

CLEANING

- Squeegee cartridge for easy replacement of blades.
- Sprayless cleaning system.
- Ability to monitor and adjust cleaner output.
- Cleaner float switches with low level warning message.
- Large waste recovery tank. (50+ lanes before emptying)
- Duster/cleaning cloth waste roll on top for easy removal.
- Patented cushion roller wrap for better cleaning.
- Super quiet DC vacuum motor.
- "Clean Only" function.
- "Dust Only" function.
- Touchscreen control of cleaner pump calibration.

FLEX WALKER

- Zero Turn Radius lane to lane walking function.
- Auto-aligning lane whisksers.
- Smart processor auto-align memory.
- Object detection.
- Automatic burn pair.

DRIVE

- Patented six variable drive speeds.
- Independent adjustable cleaning speed.
- Self-adjusting drive speeds.
- LED arrow for better operator positioning.

FLEX

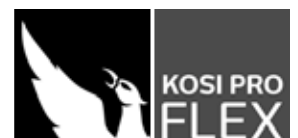

LANE MACHINE COMPARISON CHART

	FLEX WALKER	FLEX	IKON
CONDITIONING			
Sanction Technology™ fluid metering conditioning system	●	●	●
Conditions each lane in less than 90 seconds	●	●	●
Conditioner float switches with low level warning message	●	●	●
Left-Right pattern control	●	●	●
“Oil Only” function	●	●	●
Touchscreen control of microliter stream	●	●	
Touchscreen control of oil pump calibration	●	●	
DUO conditioning system (two pumps and two conditioner cartridges)	●	●	
DUO transfer system (roller and single transfer brush)	●	●	●
Two pre-filled/refillable conditioner cartridges	●	●	
Ability to alternate two conditioners in one pass	●	●	
Board-to-board pattern control	●	●	●
Measure conditioner volume per board stream before applying to lane	●	●	●
Adjustable microliter streams (per load setting)	●	●	
Different conditioners in each cartridge	●	●	
4 Variable Buffer speeds	Factory option	Factory option	
CLEANING			
Sprayless cleaning system	●	●	●
Ability to monitor and adjust cleaner output to the milliliter	●	●	●
Cleaner float switches with low level warning message	●	●	●
Large waste recovery tank (50+ lanes before emptying)	●	●	●
Duster/Cleaning cloth waste roll on top for easy removal	●	●	●
Patented cushion roller wrap for better cleaning	●	●	●
Ultra quiet DC vacuum motor	●	●	●
“Clean Only” function	●	●	●
“Dust Only” function	●	●	●
Adjustable “End Cleaning” and “Return” distance	●	●	●
Multi-adjustment squeegee assembly	●	●	●
Touchscreen control of cleaner volume	●	●	●
Squeegee cartridge for easy replacement of blades	●	●	●
Touchscreen control of cleaner pump calibration	●	●	
Cleaner supply tank with large opening for filling	●	●	●
Recovery tank with handles for better transporting/emptying	●	●	●
Self-mixing cleaner system	Factory option	Factory option	
DRIVE			
Patented six variable drive speeds	●	●	●
Independent adjustable cleaning speed	●	●	●
Self-adjusting drive speeds	●	●	●
Zero Turn Radius lane to lane walking function	●		
Auto-aligning lane whiskers	●		
Smart processor auto-align memory	●		
Object detection	●		
LED arrow for better operator positioning	●	●	
KEYPAD/PLC			
Full Color 3.5” touchscreen display			●
Full Color 5” touchscreen display	●	●	
One program for AM and PM			●
Three programs for AM and PM	●	●	
Automatic burn pair	●	●	
Stores 15 programs in memory			●
Stores 30 programs in memory	●	●	
Test input/output menu option	●	●	●
Error messages displayed			●
Full detailed error messages with help screens	●	●	
BATTERIES			
Single lightweight lithium battery	●	●	●
External battery charger	●	●	●
3 lithium battery options based on number of lanes conditioned per day	●	●	●
SPECIAL FEATURES			
KOSI™ software kit included (Kegel Online Support Interface)	●	●	●
Pin Deck treatment spray system	●	●	

KEGEL Chemical Lineup

Sanction Technology™ Lane Conditioners



TERRAIN

TERRAIN

U/I : 5 gallons (4 bottles/ 1.25 gal ea.)
 Viscosity :
 Surface Tention : dyn/cm



CURRENT

Current

U/I : 5 gallons (4 bottles/ 1.25 gal ea.)
 Viscosity : 52.0
 Surface Tention : 23.3 dyn/cm



FIRE

Fire

U/I : 5 gallons (4 bottles/ 1.25 gal ea.)
 Viscosity : 45.1
 Surface Tention : 23.6 dyn/cm



ICE

Ice

U/I : 5 gallons (4 bottles/ 1.25 gal ea.)
 Viscosity : 40.9
 Surface Tention : 23.2 dyn/cm



CURVE
LANE CONDITIONER

Curve

U/I : 5 gallons (4 bottles/ 1.25 gal ea.)
 Viscosity : 41.0
 Surface Tention : 22.0 dyn/cm



INFINITY
LANE CONDITIONER

Infinity

U/I : 5 gallons (4 bottles/ 1.25 gal ea.)
 Viscosity : 36.5
 Surface Tention : 23.1 dyn/cm
Features :
 Designed for maximum Durability. Best suited for High Linage Centers.

Sanction Technology™ Lane Conditioners

Wick-pad Conditioner

Lane Cloth

PRODIGY
LANE CONDITIONER



Prodigy

U/I : 5 gallons (4 bottles/ 1.25 gal ea.)
 Viscosity : 31.2
 Surface Tention : 23.7 dyn/cm
Features :
 Virtually eliminates ball calls and out of ranges. Back-end reaction that just won't go away.



Crossfire

U/I : 5 gallons (4 bottles/ 1.25 gal ea.)
 Viscosity : 24.1
 Surface Tention : 23.6 dyn/cm
Features :
 Specifically formulated to optimize wick/pad flow. Works very well with all other wick/pad lane machines.



K2 Select

U/I : 4 rolls (43" × 60' per roll)

Lane Cleaners

DEFENSE-C



Defense-C

U/I : 1 gallons
Features : Recommended for LOWER friction surfaces like most synthetic lanes. Provides a spotless lane and delivers stronger ball motion or extra "back-end kick".



Defense-CX4S

U/I : 1 gallons
Features : Recommended for LOWER friction surfaces like most synthetic lanes. Provides a spotless lane and delivers stronger ball motion or extra "back-end kick".

Conditioner Comparison

SANCTION TECHNOLOGY™						
PROPERTIES	CURRENT	CURVE	FIRE	ICE	INFINITY	PRODIGY
VISCOSITY (at72.5°F / 22.8°C)	52	41	45.1	40.9	36.5	31.2
CHARACTERISTICS						
Lineage(Best for)	Any	League	League/Tournament	League/Tournament	League/Tournament	Open Play
Average Pin Calls	Low/None	Low	Low/Medium	Low/Medium	Medium	Low/None
Cleanability	Easy	Moderate	Easy	Easy	Moderate	Easy
LANE SURFACES						
High Friction Surfaces	Best	Better	Good	Best	Best	Better
Medium Friction Surfaces	Best	Best	Better	Better	Better	Best
Low Friction Surfaces	Best	Better	Best	Good	Good	Best

WICK-PAD TECHNOLOGY		
PROPERTIES	PRODIGY	CROSSFIRE
VISCOSITY (at72.5°F / 22.8°C)	31.2	24.1
WICKING TIME	14minutes	10minutes
DURABILITY		
High League Lineage	5	7
High Open Play Lineage	8	6
Reduced Pinsetter Calls	9	6
Easy Cleaning	7	8
Limits Carry Down	8	9
LANE SURFACES		
Pro Lane™	9	8
Anvilane™	8	10
AMF HPL™	8	8
AMF SPL™	6	8
Laneshield®	8	10
Guardian®	5	7
MAD Lanes®	7	9
WOOD FINISHES		
Water Base	5	9
100% Solids	5	9

Coaching Tools



Specto is a new tracking system for centers, bowlers, and coaches. It records information about bowlers' shots using a high-power sensor and displays it to them on an easy-to-use app.



Simply order a Specto system and allow your bowlers to use your Specto Lanes. Your bowlers will easily be able to connect to the Specto app to view their stats, perform practice drills on their own, or compete in challenges with friends and bowlers worldwide. This fun tool can help bowlers improve and create a buzz in your center.

Specto Complete System - 157-8602 (115v/60Hz)
 Specto Complete System - 157-8602E (220v/50Hz)



KEGEL is excited to announce updates to the Specto bowling app including the new module Specto worlds: A new experience and environment for every bowler.



Coaching Tools



TORCH

One of the most difficult things for a bowler to do is visualize the ball path from the foul line to the breakpoint. From entry level bowlers to the most advanced, the Torch allows bowlers to see the initial path of the bowling ball like no other product before.

The Torch is a simple light targeting tool used to help with accuracy and alignment. Using LED lights, it reflects a path of light on the lane to help you select the correct launch angle and hit your target time after time. As the player moves left and right, the light will change its position showing you exactly where you should throw the ball.

The Torch was designed to explain the aiming process in a way that can be easily understood by everyone. From children, to beginning bowlers, to special needs bowlers, the Torch is an easy and fun way to quickly improve this important fundamental skill.

Torch Complete System - 157-8800 (115v/60Hz-220v/50Hz)
Optional Battery Upgrade - 157-8801



3D REFERENCE TOOL

The Arrow is a 3D Reference Tool that gives players a physical reference point to see when working on a variety of drills. Visualize your set-up position, pushaway, finish position and more! Compare your technique to something you can see and feel to train yourself quickly. This dynamic tool can take the place of many coaching aids.





BOWLING CATALOG 2020-2021

ABS International Corp.
www.abs300.com



**WE ARE
THE LARGEST
DISTRIBUTOR AND
MANUFACTURER OF
BOWLING SUPPLIES
IN THE FAR EAST.**

Head Office
1-1-1 Kitamagome, Ota-ku, Tokyo,
143-0021, Japan Fax. +81-3-5718-7122

ABS International Corp.
is the foreign trade division of
American Bowling Service, Inc.,
Japan.

Special Thanks,

- Location: Enoshima Bowling Center /
- Model: Ms. Shinobu Kawase (Pepi)
Mr. Naruhito Yamada (Bowlarrow Hachinohe)

- Products featured may differ slightly
in color and design to the actual product due
to the printing process and use of prototypes
in the production of this catalog.

